

Wireless Speaker Sounder

USER GUIDE

Document SAP: 102028024-01



! This product contains a flashing light which may potentially trigger seizures for people with photosensitive epilepsy

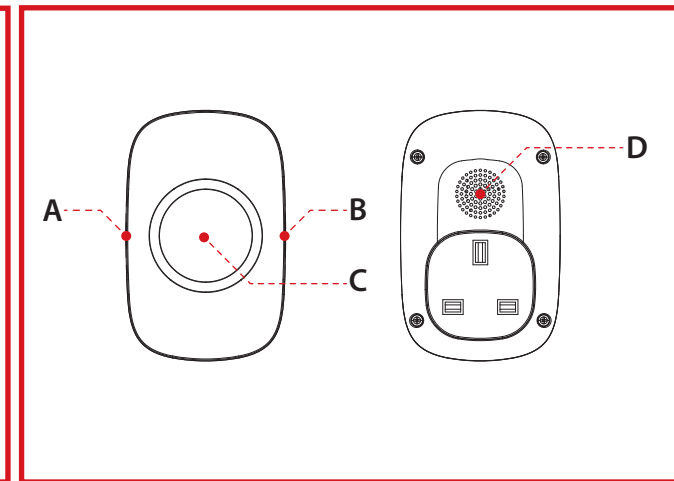
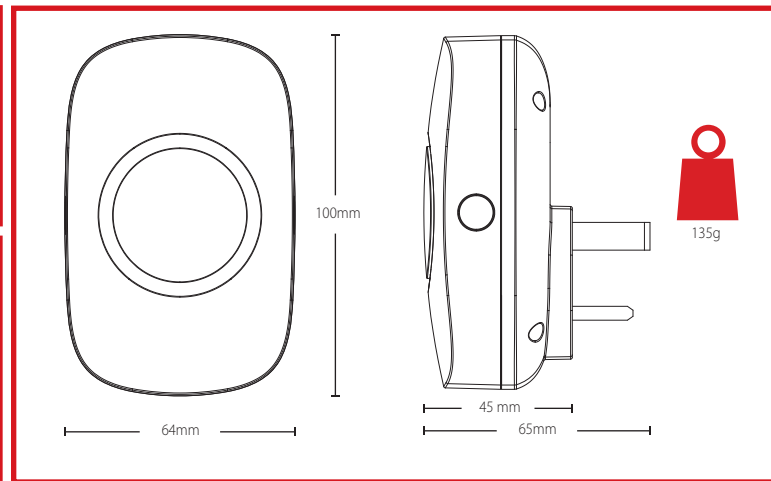

EN Dimensions and weight

Please see diagram for dimensions and weight of product.

Sounder overview

- A. Alarm volume adjust
- B. Chime volume adjust
- C. Visual indicator area
- D. Speaker

1. Configuration mode

Whilst powered up, press both the alarm and chime volume adjust buttons simultaneously and hold for 2 seconds. The blue LED will illuminate to indicate the sounder is in configuration mode. Configuration mode will automatically timeout after 10 seconds of inactivity.

2. Enabling and disabling the light

Press both the alarm and chime volume adjust buttons simultaneously whilst the sounder is in configuration mode to switch between the light enabled and disabled. The white light will extinguish/illuminate to show the current setting.

3. Alarm volume

In configuration mode, press the alarm volume adjust button to cycle through volume levels 1 to 4 and mute. The red LED will illuminate whilst cycling through. The first button press plays the Alarm tone at the current setting, subsequent presses adjust the volume.

4. Chime volume

In configuration mode, press the chime volume adjust button to cycle through volume levels 1 to 4 and mute. The red LED will illuminate whilst cycling through. The first button press plays the Chime tone at the current setting, subsequent presses adjust the volume.

5. Exiting configuration mode

The sounder will automatically exit configuration mode if no buttons have been pressed on the device for 10 seconds.

6. Mains fail operation

- Audible response

The device will double beep 5 times and then will pause for 30 minutes. At the end of 30 minutes the device will enter a cycle of double beeping 5 times then pausing for 10 seconds.

The cycle will repeat until the device runs out of battery, the device is turned off or the mains power is restored.

- Visual response

The device will illuminate and stay illuminated until the device runs out of battery, the device is turned off or the mains power is restored.

7. Powering the device off

Switch mains supply off or remove the device from the wall socket. Press and hold both volume buttons until the device LEDs all extinguish.

Specifications

Casing

3mm polycarbonate

LED colours

Blue, red, green and white

Transmission frequency

868MHz FM transceiver narrow band

Transmission method and range

Fully encrypted rolling code, 300m

Operating voltage

230VAC ±5%, 50Hz

Operating current

40mA @ 230VAC

Operating temperature

-10 to 40°C

Battery

3.7V 250mAh, Lithium-ion, non-replaceable

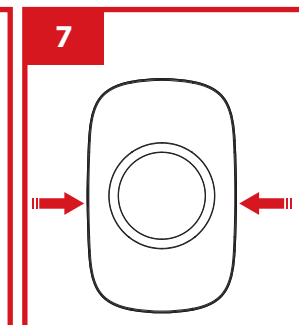
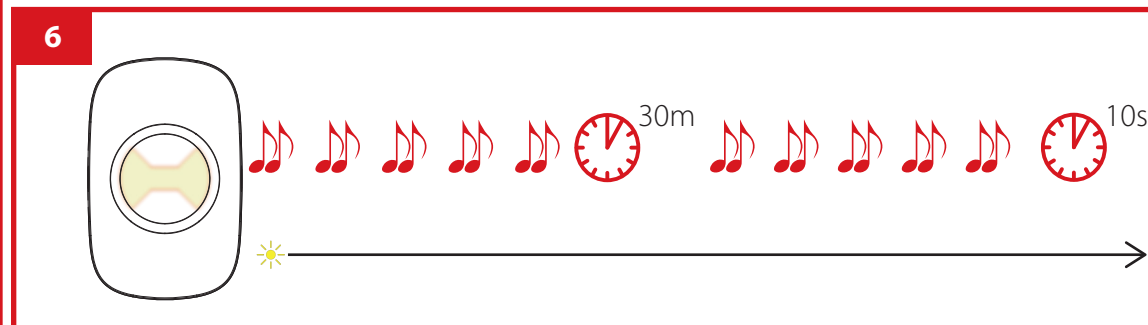
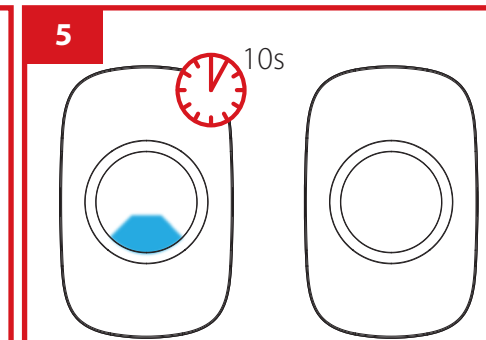
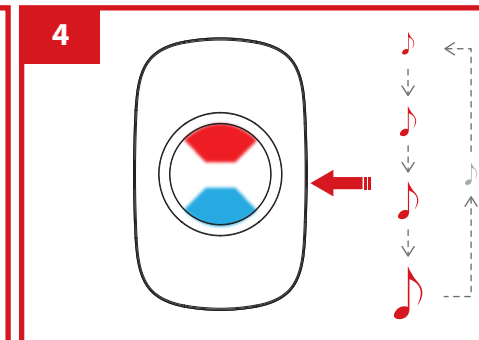
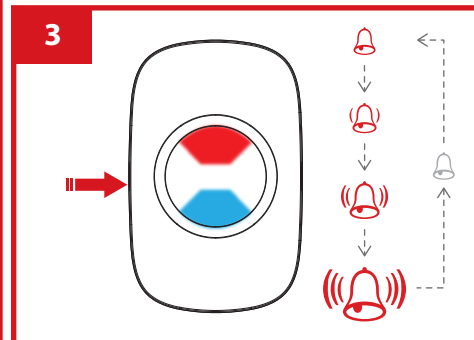
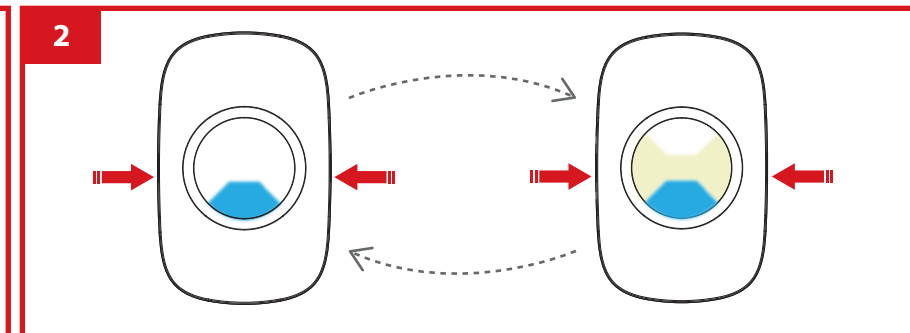
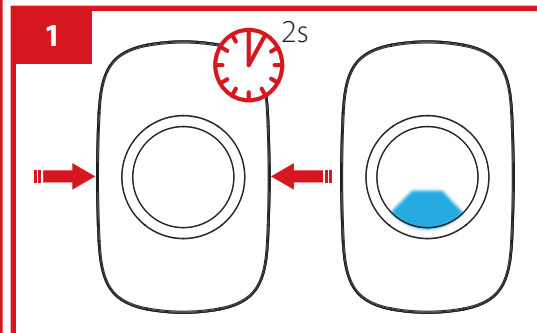



Alarm response

- Audible response

Rapid tones alternating high and low.

- Visual response

Rapid flashing white LED light.



Chime response

- Audible response

Slow repeating tones (if chime follow is selected) or singular tone otherwise.

- Visual response

Slow flashing white LED light.



Fire and personal attack response

- Audible response

Slow tones alternating from low to high.

- Visual response

The white LED illuminates and stays on constantly.



Entry and/or exit response

- Audible response

A constant tone is on whilst the entry or exit timer is active.

- Visual response

The white LED illuminates and stays on constantly.

Product information

Applies to electrical products sold within the European community. At the end of the electrical product's life, do not dispose of it with household waste. Where possible, recycle the product. Check with your Local Authority or retailer for recycling advice in your country. When disposing of the product, the battery must be removed and disposed of separately in accordance with the local regulations. Hereby Pyronix declares that this product is in compliance with the essential requirements and other relevant provisions of Directive 2014/53/EU. The declaration of conformity may be consulted at www.pyronix.com/product-compliance.php

Warranty

This product is sold subject to our standard warranty conditions and is warranted against defects in workmanship for a period of two years. In the interest of continuing care and design, Pyronix Ltd reserves the right to amend specifications without giving prior notice.

